

# CDM091

ENCLOSED TYPE

- Material : Engineering Plastic with Glass Fiber +  $\alpha$
- Speed : 3 m/sec
- Temperature : -25 ~ 125°C



## Structure

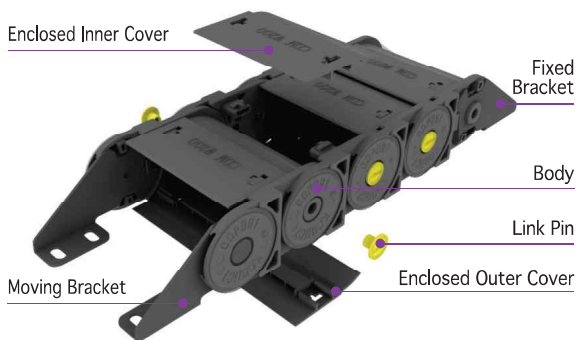

## Load Diagrams Self-Supporting Length

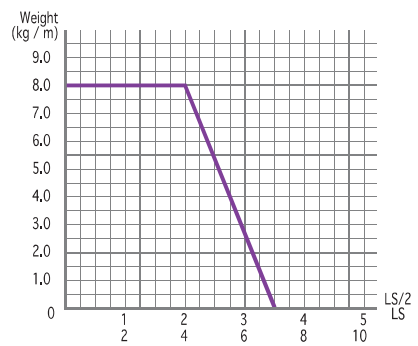

## End Bracket

### Fixed Bracket

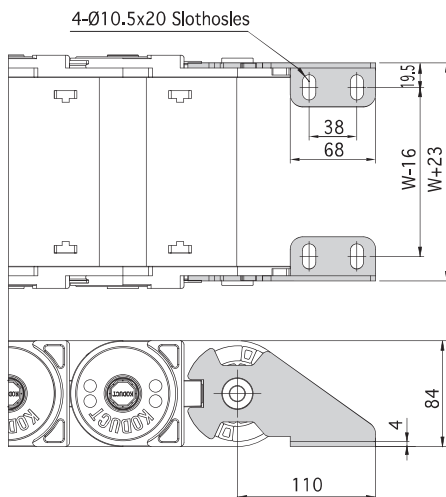

### Moving Bracket

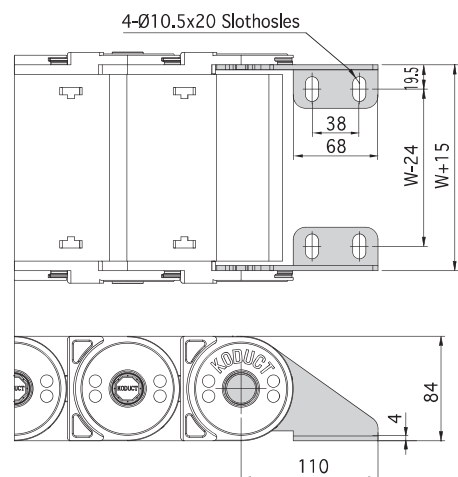

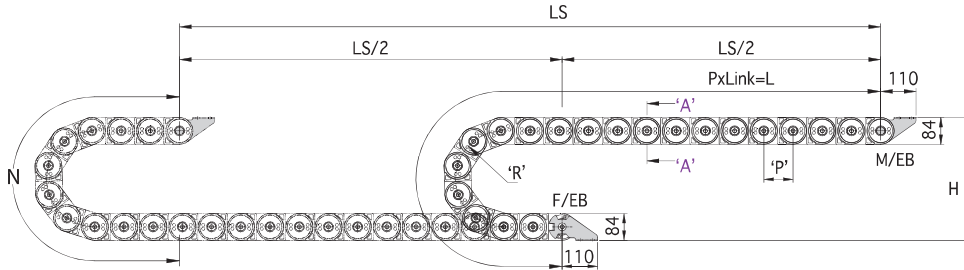

$L = \frac{LS}{2} + N$

LS: Total Machine Travel, L: Length, N: Safety Length+πr,  
 H: Height, P: Pitch, M/EB: Moving End Bracket, F/EB: Fixed End Bracket

Section A-A

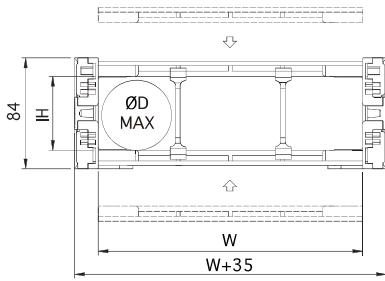

Divider

\* Separator: 20.8X6(Plastic)

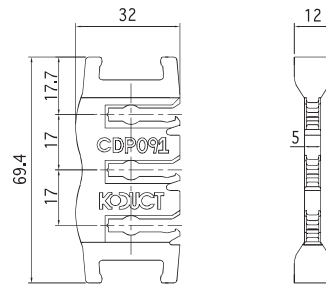

Specification

TYPE	W mm(inch)	Radius mm(inch)	Pitch mm(inch)	IH mm(inch)	ØD MAX	Height mm(inch)	N mm(inch)	DVDR (ea)	1M (kg)	EB Set (kg)
CDM091	150 (5.906)	150 (5.906)	91 (3.583)	47 (1.850)	Ø25	384 (15.118)	835 (32.874)	2	4.126	1.080
	200 (7.874)	200 (7.874)		51 (2.008)	Ø33	484 (19.055)	992 (39.055)	2	4.700	
	250 (9.843)	250 (9.843)		55 (2.165)	Ø51	584 (22.992)	1,149 (45.236)	3	5.229	
	300 (11.811)	300 (11.811)		55 (2.165)		684 (26.929)	1,306 (51.417)	3	5.908	

\* 1inch = 25.4mm