

CDP080

PLASTIC COVER TYPE

- Material : Engineering Plastic with Glass Fiber + α
- Speed : 5 m/sec
- Temperature : -25 ~ 125°C



Structure

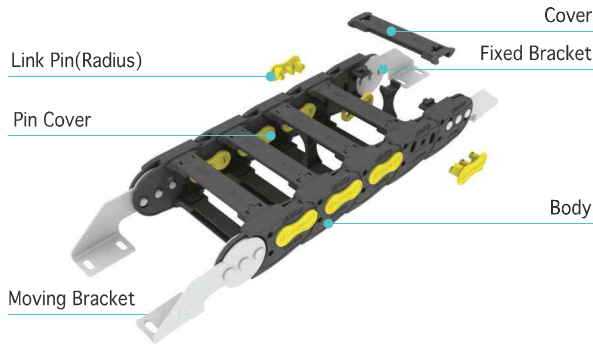

Load Diagrams Self-Supporting Length

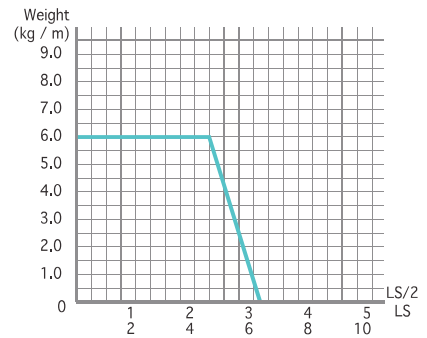

End Bracket

Fixed Bracket

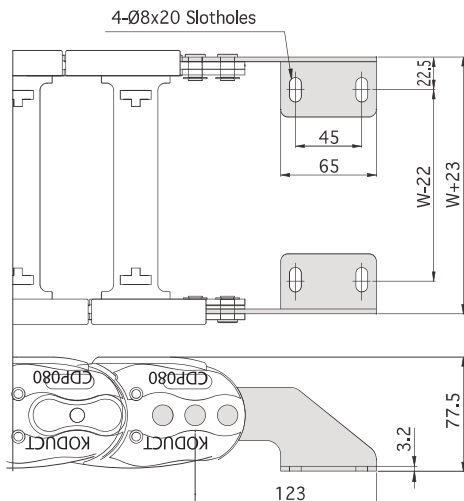

Moving Bracket

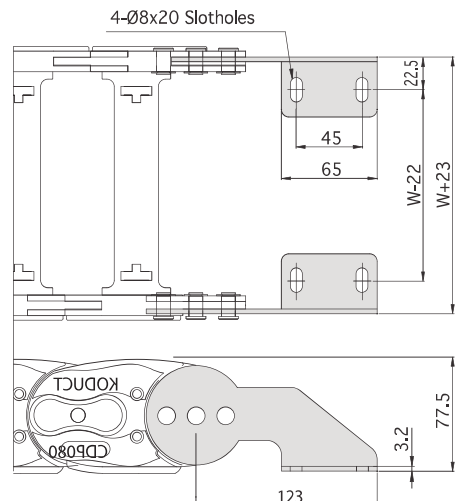

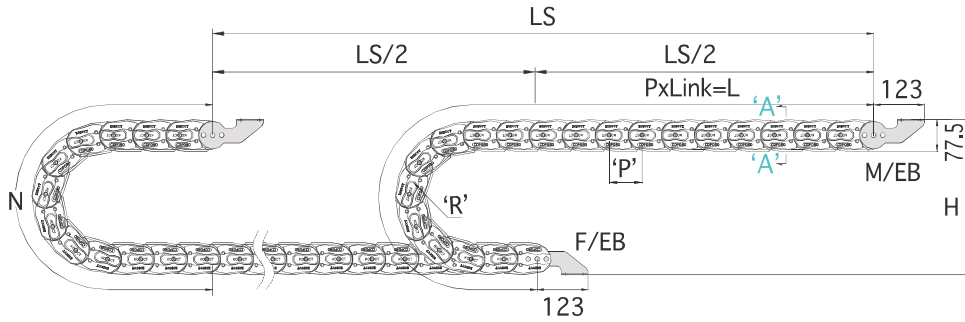

$$\left[L = \frac{LS}{2} + N \right]$$

LS: Total Machine Travel, L: Length, N: Safety Length+πr,
 H: Height, P: Pitch, M/EB: Moving End Bracket, F/EB: Fixed End Bracket

Section A-A

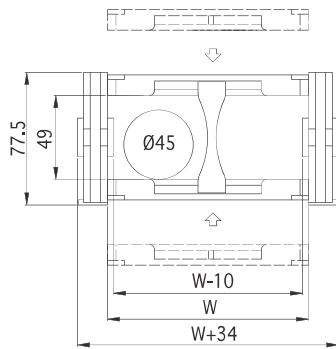

Divider

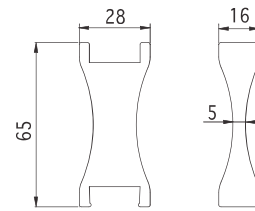

Specification

| TYPE | W mm(inch) | Radius mm(inch) | Pitch mm | Height mm(inch) | N mm(inch) | DVDR (ea) | 1M (kg) | EB Set (kg) |
|--------|---------------|--------------------|-------------|--------------------|----------------|--------------|------------|----------------|
| CDP080 | 100 (3.937) | 150 (5.906) | 80 (3.150) | 376 (14.803) | 791 (31.142) | 1 | 3.368 | 1.435 |
| | 150 (5.906) | 150 (5.906) | | 376 (14.803) | 791 (31.142) | 2 | 3.785 | |
| | 200 (7.874) | 200 (7.874) | | 476 (18.740) | 948 (37.323) | 2 | 4.045 | |
| | 250 (9.843) | 250 (9.843) | | 576 (22.677) | 1,105 (43.504) | 3 | 4.437 | |
| | 300 (11.811) | 250 (9.843) | | 636 (25.039) | 1,199 (47.205) | 3 | 4.826 | |
| | 350 (13.780) | 280 (11.024) | | 636 (25.039) | 1,199 (47.205) | 4 | 4.983 | |
| | 400 (15.748) | 400 (15.748) | | 876 (34.488) | 1,576 (62.047) | 4 | 5.399 | |

* 1Inch = 25.4mm