

CDS100

ALUMINUM BAR TYPE

- Material : Engineering Plastic with Glass Fiber + α + Aluminum Bar
- Speed : 5 m/sec
- Temperature : -25 ~ 125°C

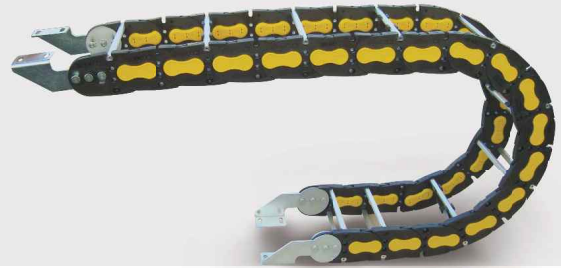

Structure

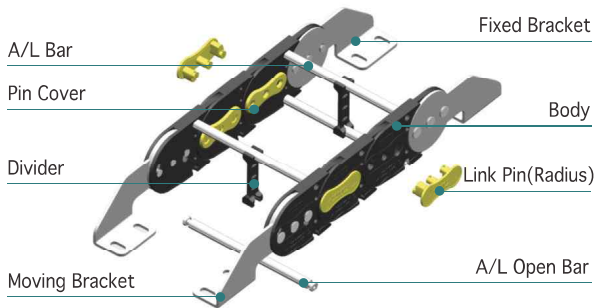

Load Diagrams Self-Supporting Length

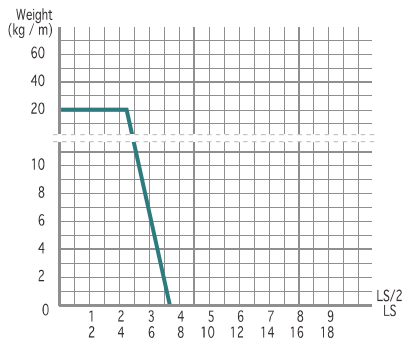

End Bracket

Fixed Bracket

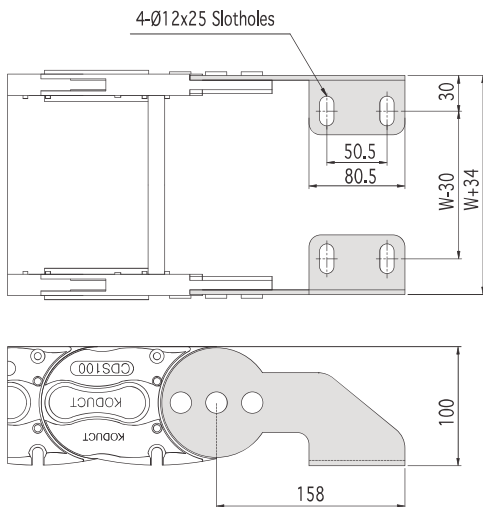

Moving Bracket

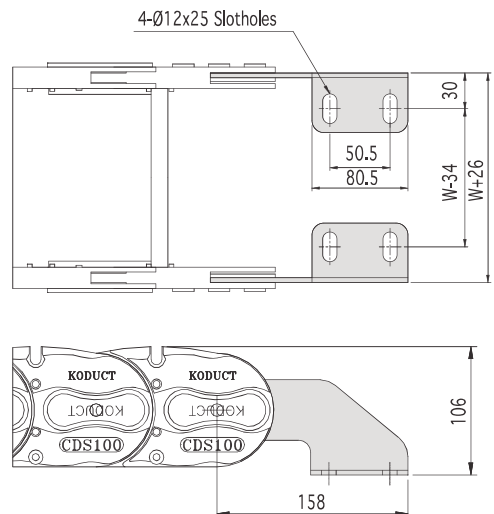

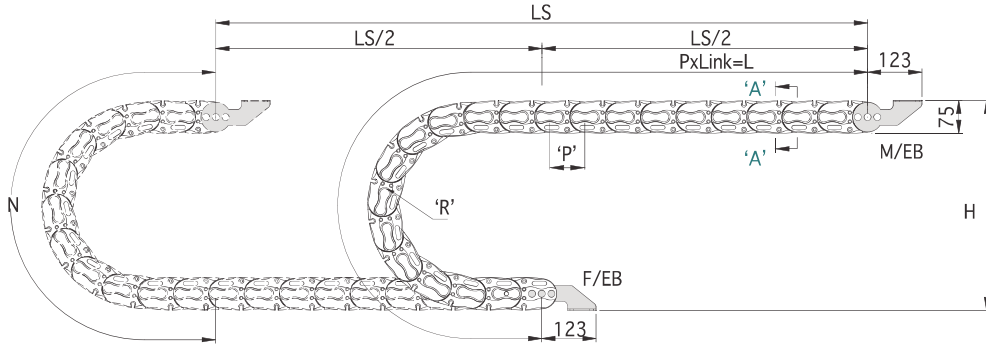

$$\left[L = \frac{LS}{2} + N \right]$$

LS: Total Machine Travel, L: Length, N: Safety Length+πr,
 H: Height, P: Pitch, M/EB: Moving End Bracket, F/EB: Fixed End Bracket

Section A-A

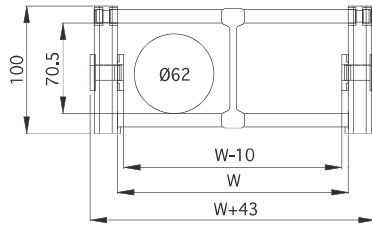

Divider

* Separator : Ø6(Aluminum)

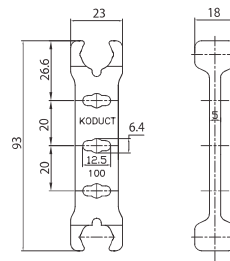

Specification

| TYPE | W mm(inch) | Radius mm(inch) | Pitch mm | Height mm(inch) | N mm(inch) | DVDR (ea) | 1M (kg) | EB Set (kg) |
|--------|---------------|--------------------|-------------|--------------------|----------------|--------------|------------|----------------|
| CDS100 | 100 (3.937) | 200 (7.874) | 100 (3.937) | 504 (19.842) | 1,028 (40.472) | 1 | 3.833 | 3.043 |
| | 150 (5.905) | 250 (9.843) | | 604 (23.779) | 1,185 (46.653) | 2 | 4.069 | |
| | 200 (7.874) | | | 704 (27.716) | 1,342 (52.835) | 2 | 4.238 | |
| | 250 (9.843) | 300 (11.811) | | 804 (31.653) | 1,499 (59.016) | 3 | 4.471 | |
| | 300 (11.811) | 350 (13.779) | | 904 (35.590) | 1,656 (65.197) | 3 | 4.638 | |
| | 350 (13.779) | 400 (15.748) | | 1,104 (43.464) | 1,970 (77.559) | 4 | 4.913 | |
| | 400 (15.748) | 500 (19.685) | | 행의 | 행의 | 4 | 5.081 | |
| | 500 (19.685) | 600 (23.622) | | 행의 | 행의 | 행의 | 6.758 | |
| | | | | | | 행의 | 7.317 | |

* Width 주문에 따라 제작가능 (Width follows in oder)

* 1inch = 25.4mm