

KDM100

ENCLOSED TYPE

- Material : Engineering Plastic with Glass Fiber + α
- Speed : 5 m/sec
- Temperature : -25 ~ 125°C



Structure

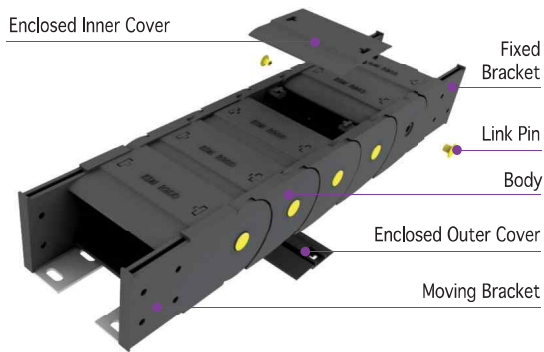

Load Diagrams Self-Supporting Length

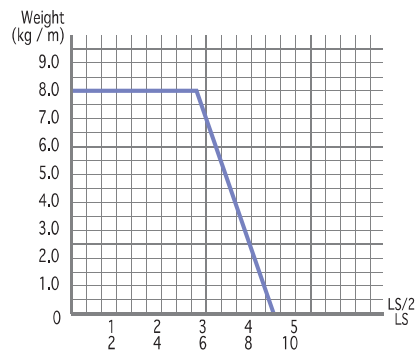

End Bracket

Fixed Bracket

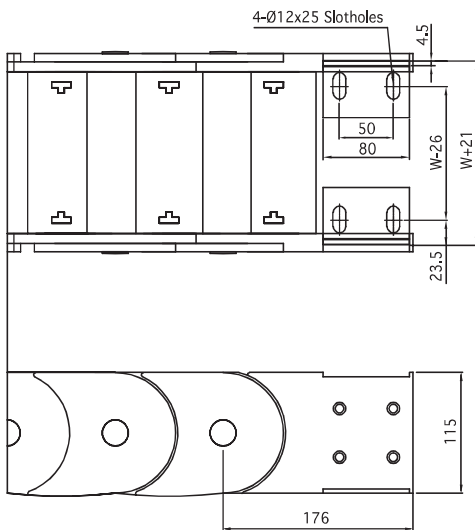

Moving Bracket

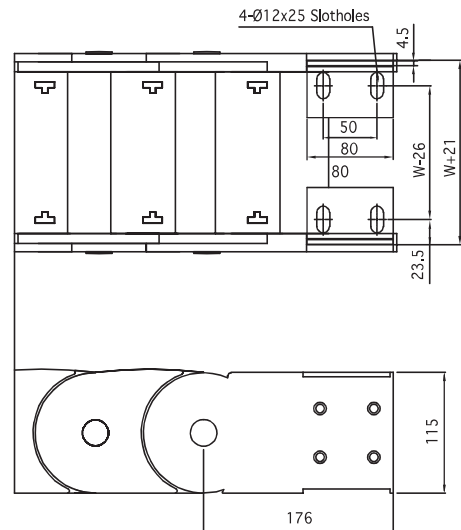

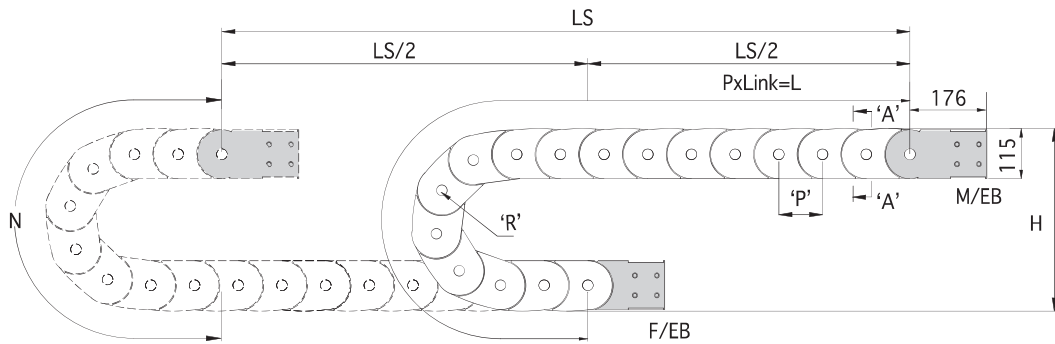

$$\left[L = \frac{LS}{2} + N \right]$$

LS: Total Machine Travel, L: Length, N: Safety Length+πr,
 H: Height, P: Pitch, M/EB: Moving End Bracket, F/EB: Fixed End Bracket

Section A-A

Divider

* Separator : Ø6(Aluminum)

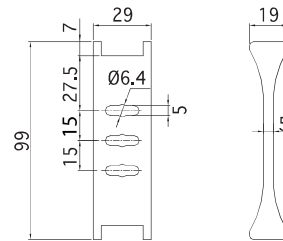
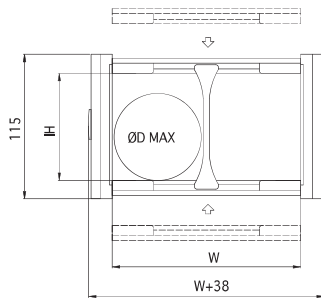

Specification

TYPE	W mm(inch)	Radius mm(inch)	Pitch mm(inch)	IH mm(inch)	ØD MAX	Height mm(inch)	N mm(inch)	DVDR (ea)	1M (kg)	EB Set (kg)
150 (5.906)	200 (7.874)	200 (7.874)	100 (3.937)	80 (3.150)	Ø33	518 (20.394)	1,028 (40.472)	2	5.091	1.870
		250 (9.842)		82 (3.228)	Ø42	618 (24.331)	1,185 (46.653)			
KDM100	200 (7.874)	300 (11.811)	100 (3.937)	85 (3.346)	Ø50	718 (28.268)	1,342 (52.835)	2	5.515	1.870
		350 (13.780)		85 (3.346)	Ø58	818 (32.205)	1,499 (59.016)			
		400 (15.748)		85 (3.346)	Ø66	918 (36.142)	1,656 (65.197)			

* 1inch = 25.4mm