

KM90

ENCLOSED TYPE

- Material : Engineering Plastic with Glass Fiber + α
- Speed : 3 m/sec
- Temperature : -25 ~ 125°C



Structure

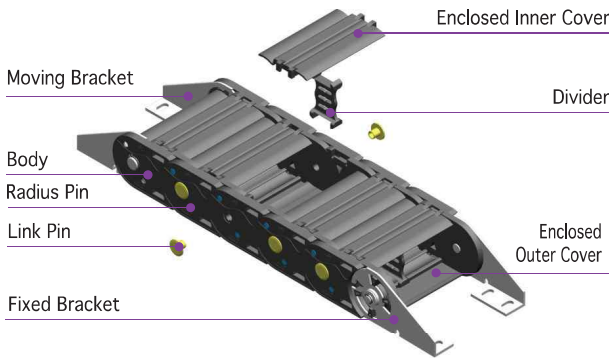

Load Diagrams Self-Supporting Length

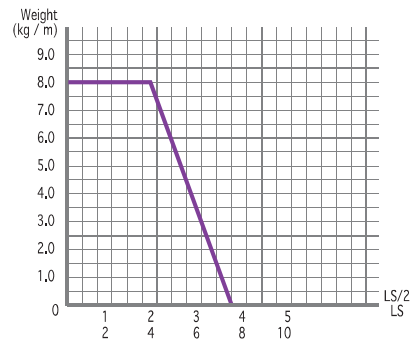

End Bracket

Fixed Bracket

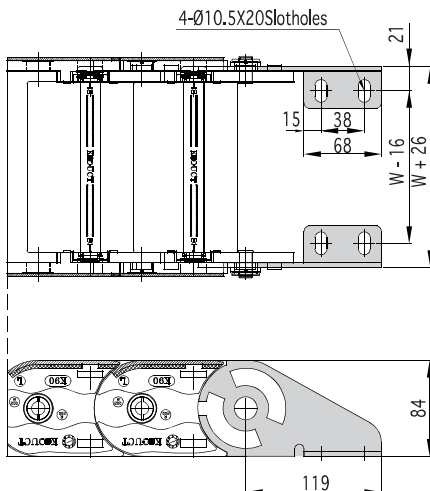

Moving Bracket

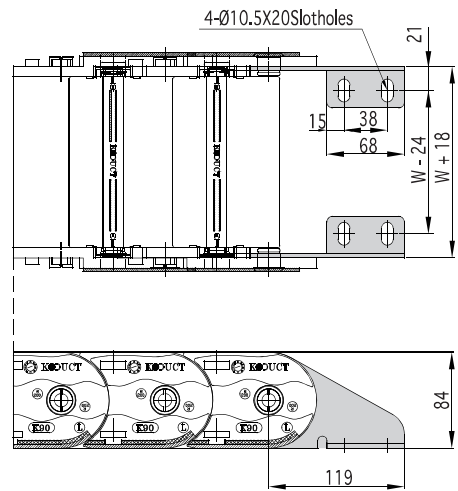

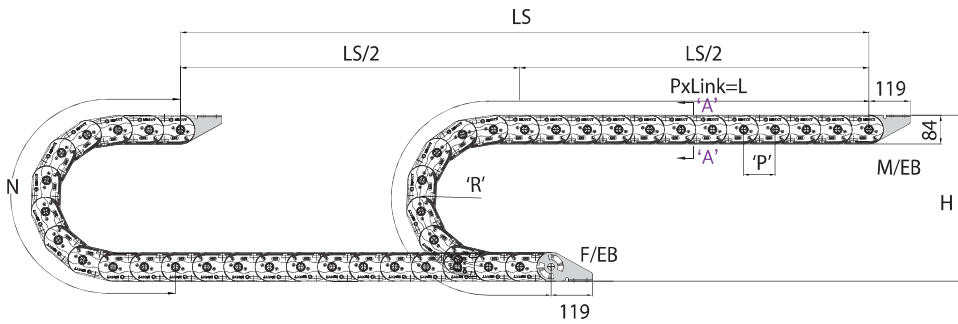

$$L = \frac{LS}{2} + N$$

LS: Total Machine Travel, L: Length, N: Safety Length+πr,
 H: Height, P: Pitch, M/EB: Moving End Bracket, F/EB: Fixed End Bracket

Section A-A

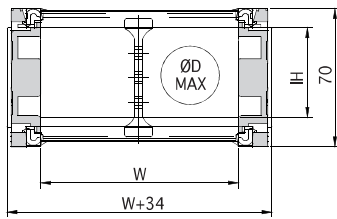

Divider

* Separator: Ø7(Aluminum)

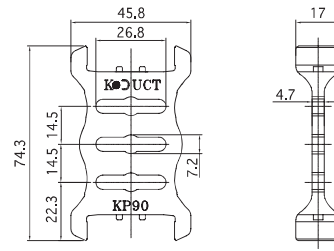

Specification

TYPE	W mm(inch)	Radius mm(inch)	Pitch mm(inch)	IH mm(inch)	ØD MAX	Height mm(inch)	N mm(inch)	DVDR (ea)	1M (kg)	EB Set (kg)
KM90	150 (5.906)	150 (5.906)	91 (3.582)	47 (1.850)	Ø25	384 (15.118)	835 (32.874)	2	6.782	1.160
		200 (7.874)		51 (2.008)	Ø33	484 (19.055)	992 (39.055)			
	200 (7.874)	250 (9.842)	91 (3.582)	54 (2.125)	Ø41	584 (22.992)	1,149 (45.236)	2	8.828	
		300 (11.811)		54 (2.125)	Ø41	684 (26.929)	1,306 (51.417)			

* 1inch = 25.4mm